

LOC		DIST		REVISIONS				
P	LTR	DESCRIPTION	DATE	OWN	APVD			
A		CHANGE PART STATUS TO ACTIVE EC-1003034	19JUL2010	TR	KZ			
B		ECO-12-013650	12OCT2012	GZ	KZ			
C		ECO-13-001347	25JAN2013	GZ	KZ			

- MATERIAL:  
 HOUSING: BLACK, THERMOPLASTIC, RATED UL 94V-0.  
 SHIELD: COPPER ALLOY WITH NICKEL PLATING.  
 CONTACTS: PHOSPHOR BRONZE.  
 CONTACT PLATING: 0.05µm MIN GOLD OVER  
 0.76µm MIN PALLADIUM-NICKEL, AT MATING  
 INTERFACE CONTACT AREA.
- TE LOGO, PART NUMBER, DATE CODE AND  
 COUNTRY OF ORIGIN, SHOWN APPROXIMATE AREA.
- LED IS DRIVEN WITH CURRENT AT APPROX 20 mA  
 DOMINANT WAVELENGTH (λD): GREEN 573 nm TYP AT IF=20mA  
 FORWARD VOLTAGE (VF): GREEN 2.0V TYP at IF=20mA  
 DOMINANT WAVELENGTH (λD): RED 624 nm TYP AT IF=20mA  
 FORWARD VOLTAGE (VF): RED 2.0V TYP at IF=20mA  
 DOMINANT WAVELENGTH (λD): YELLOW 589 nm TYP AT IF=20mA  
 FORWARD VOLTAGE (VF): YELLOW 2.0V TYP at IF=20mA
- RECOMMENDED MIN PCB THICKNESS 1.5mm (.062").
- DATUM AND BASIC DIMENSION ESTABLISHED BY CUSTOMER.
- FOR HOLE SIZE AND PLATINGS, SEE SHEET 4.
- APPLICATION 10/100/1000 BASE-T  
 -IMPEDANCE 100 OHMS  
 -PERFORMANCE:  
 ALL PAIRS ARE BI-DIRECTIONAL  
 T1A-568-C.2 CATEGORY 5E COMPLIANT  
 INSERTION LOSS:  
 1<F<6.3MHZ = .01dB (MAX)  
 6.3<F<100MHZ = .04X SQRT(F)dB (MAX)  
 RETURN LOSS:  
 1<F<31.5MHZ = 30dB (MIN)  
 31.5<F<100MHZ = 20-(20XLOG(F/100))dB (MIN)  
 NEXT LOSS:  
 1<F<7.9MHZ = 65dB (MIN)  
 7.9<F<100MHZ = 43-(20XLOG(F/100))dB (MIN)  
 NEXT LOSS:  
 1<F<3.2MHZ = 65dB (MIN)  
 3.2<F<100MHZ = 35.1-(20XLOG(F/100))dB (MAX)  
 -ISOLATION VOLTAGE: 2250VDC(MAX) FOR 60 SECONDS WITH  
 A RISE TIME OF 500V/SEC.

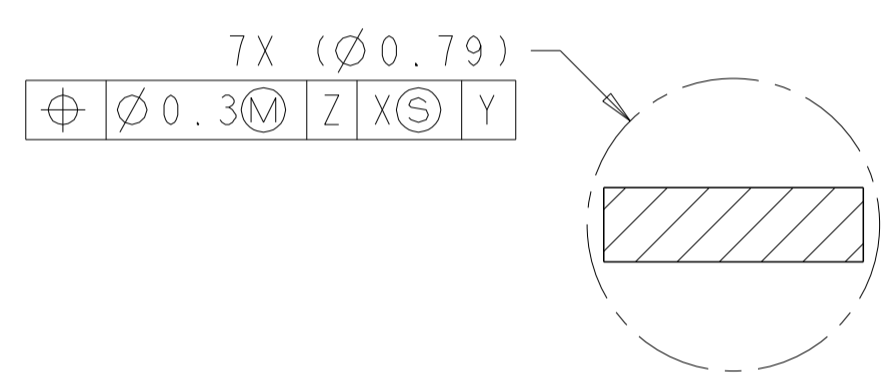

SECTION U-U  
 SCALE 50:1

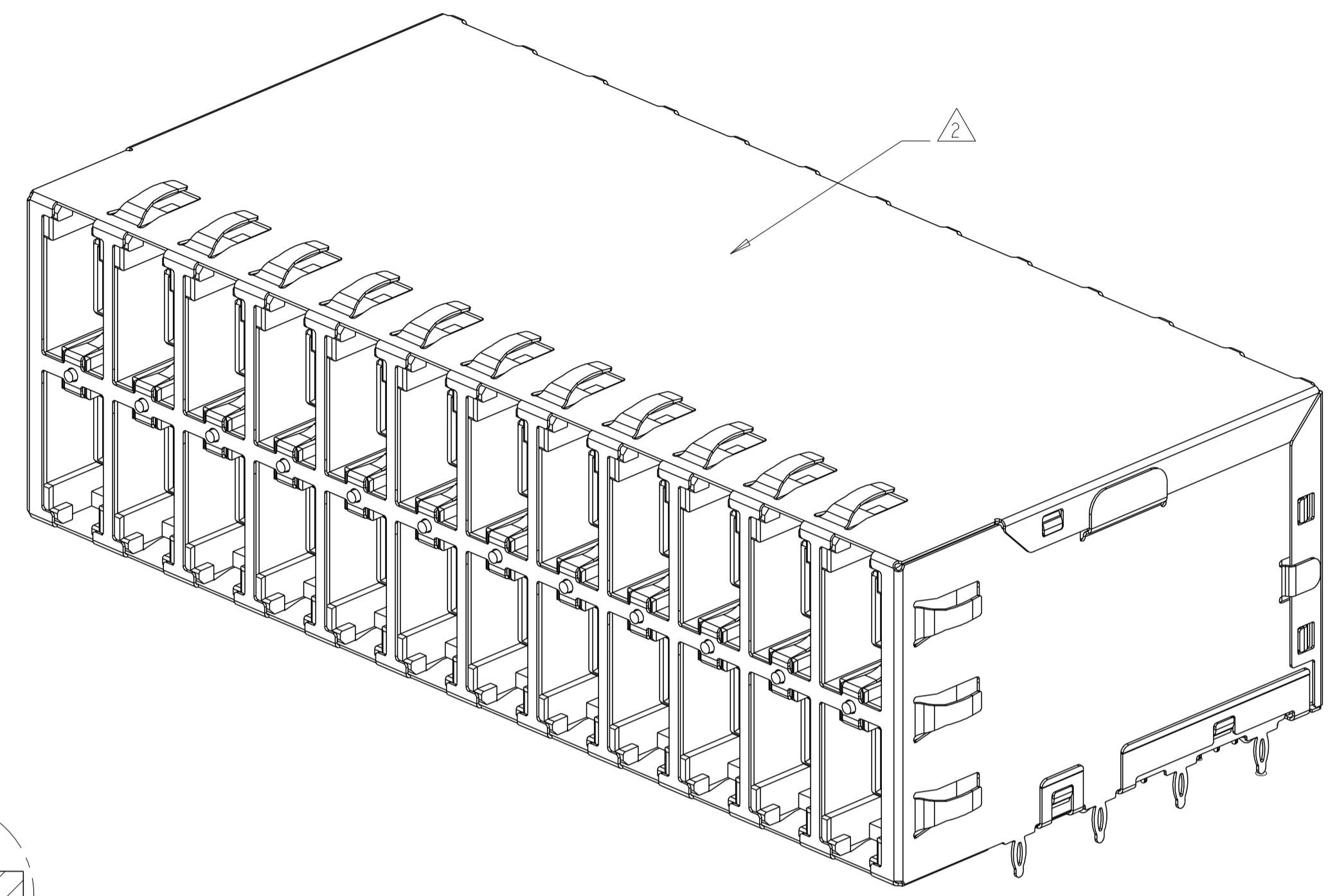
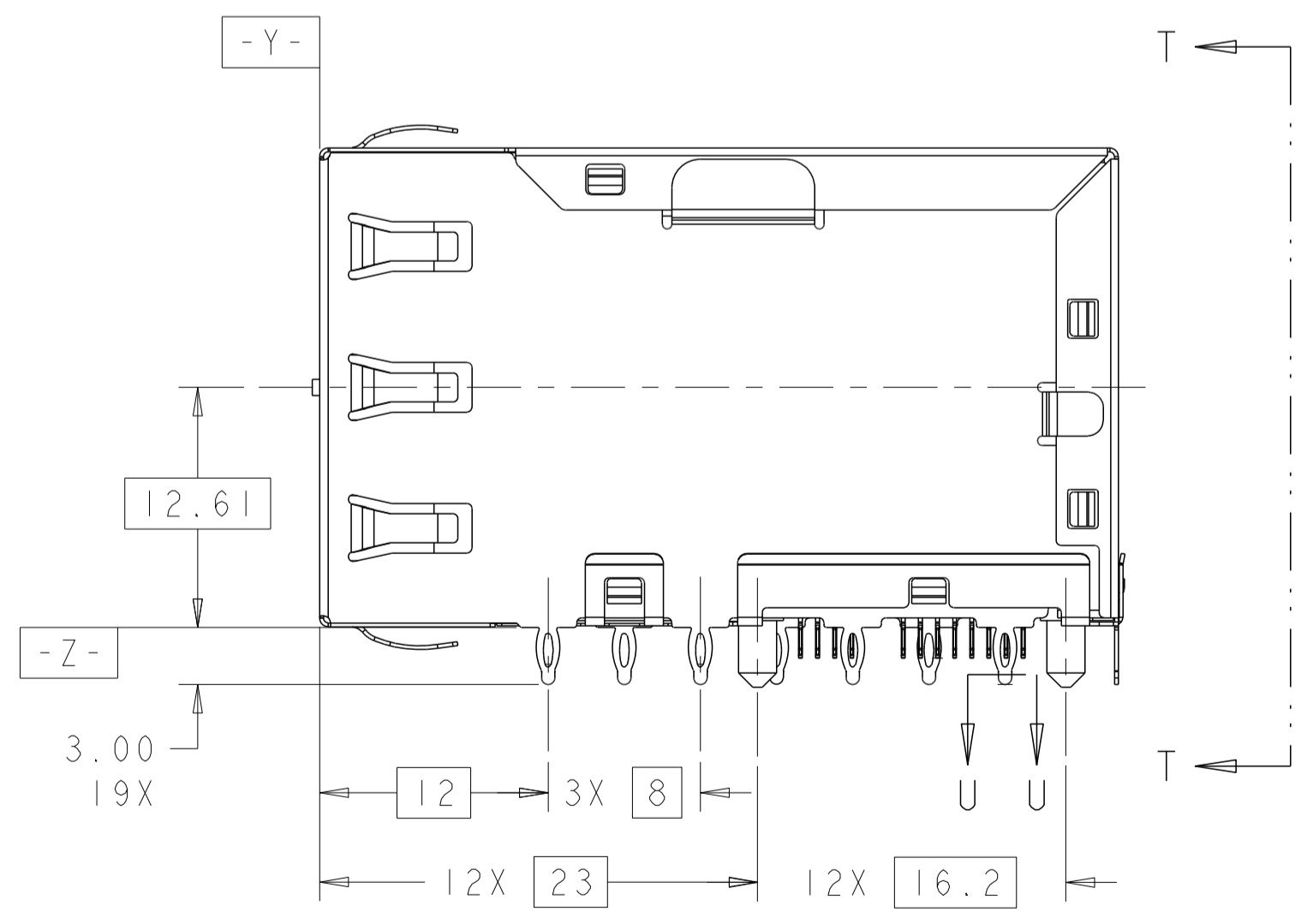
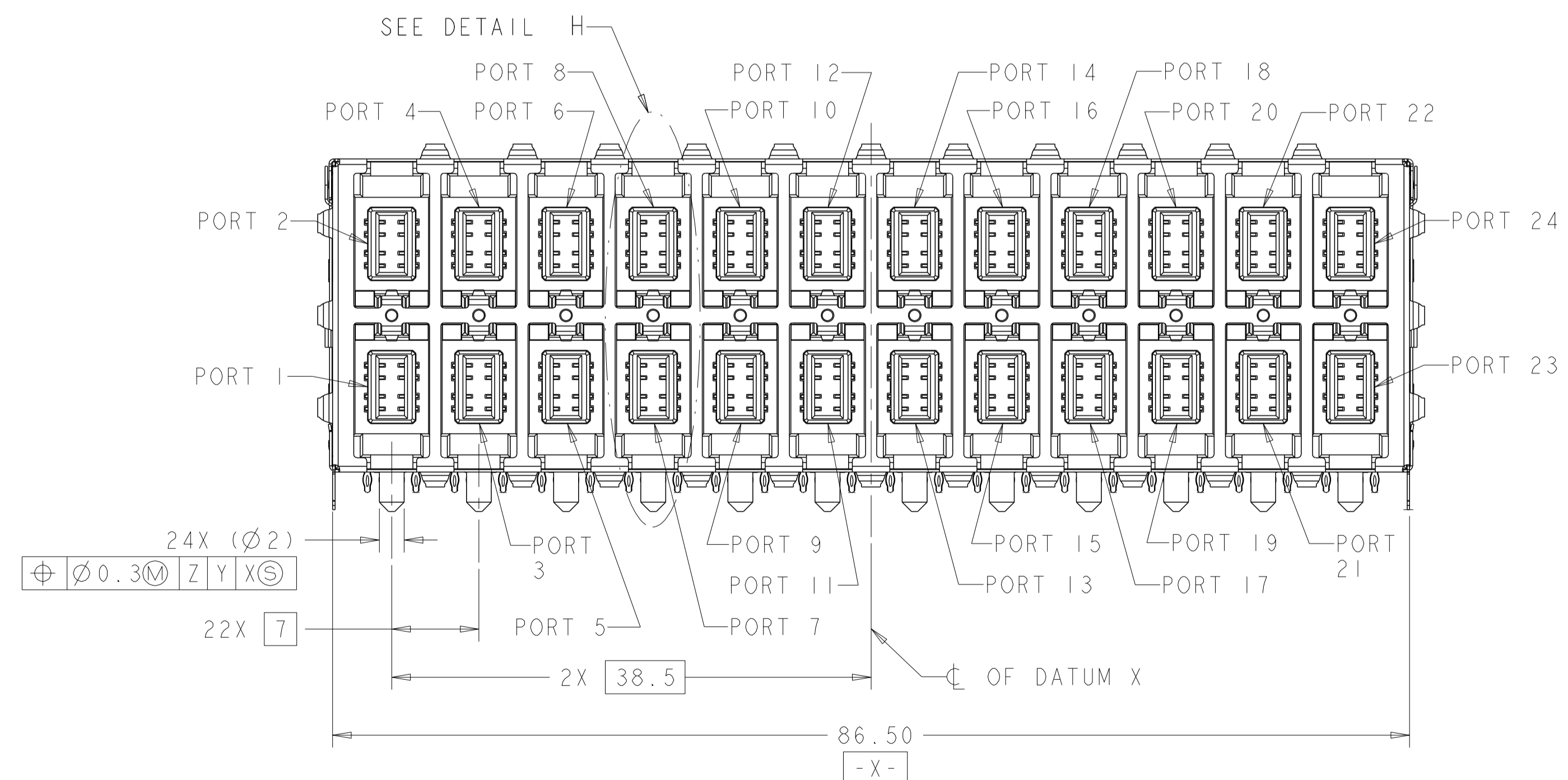
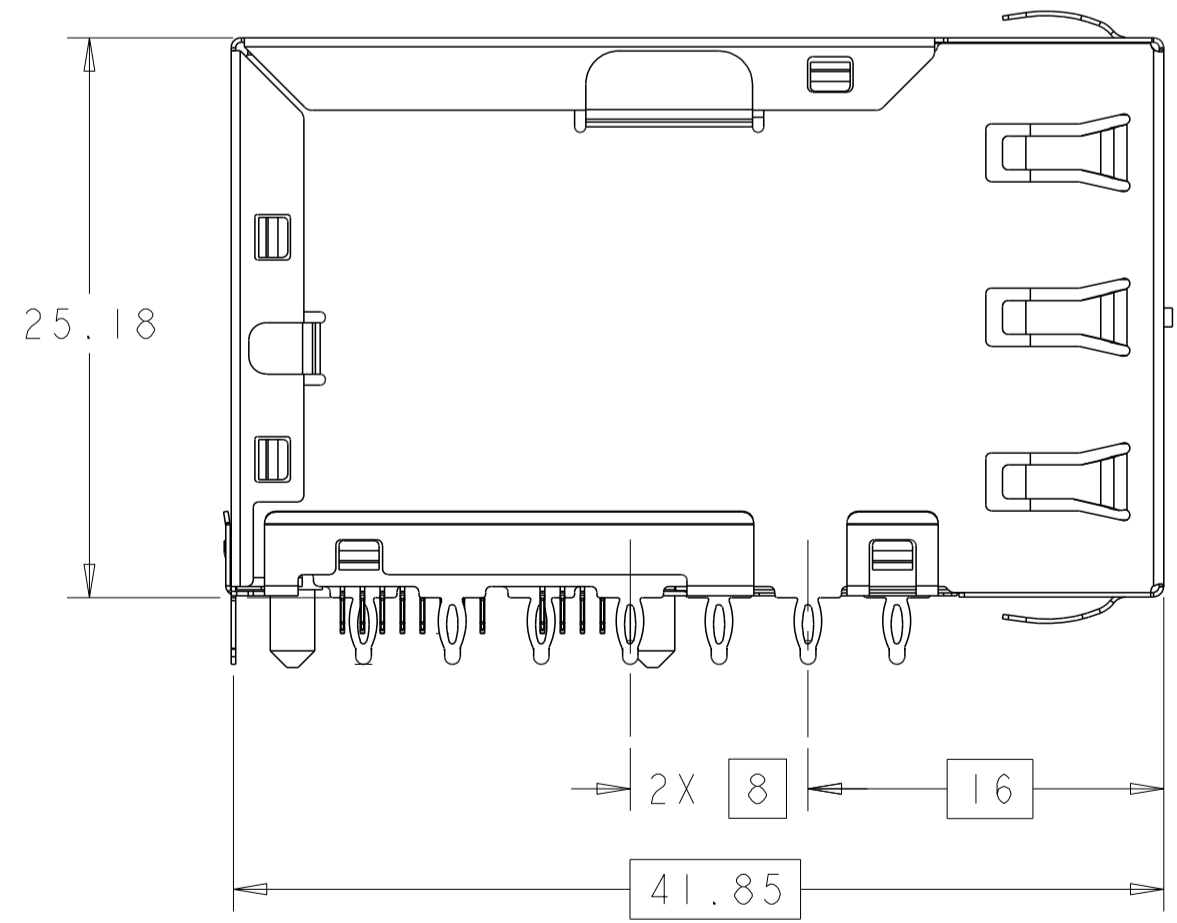

YELLOW/GREEN BI-COLOR	2057134-2
RED/GREEN BI-COLOR	2057134-1
LED COLORS	PART NUMBER

THIS DRAWING IS A CONTROLLED DOCUMENT. DWN M. SHIRK 08APR2008  
 CWR B. HENRY 08APR2008  
 APVD B. HENRY 08APR2008

STC TE Connectivity

RECEPTACLE ASSEMBLY,  
 2X12, NON MAGNETICS, RJ POINT FIVE

SIZE: CAGE CODE: DRAWING NO: RESTRICTED TO  
 A 100779 ©=2057134

CUSTOMER DRAWING SCALE: 3:1 SHEET 1 OF 5 REV C

LOC	DIST	REVISIONS			
P	LTR	DESCRIPTION	DATE	DWN	APVD
-	-	SEE SHEET 1	-	-	-

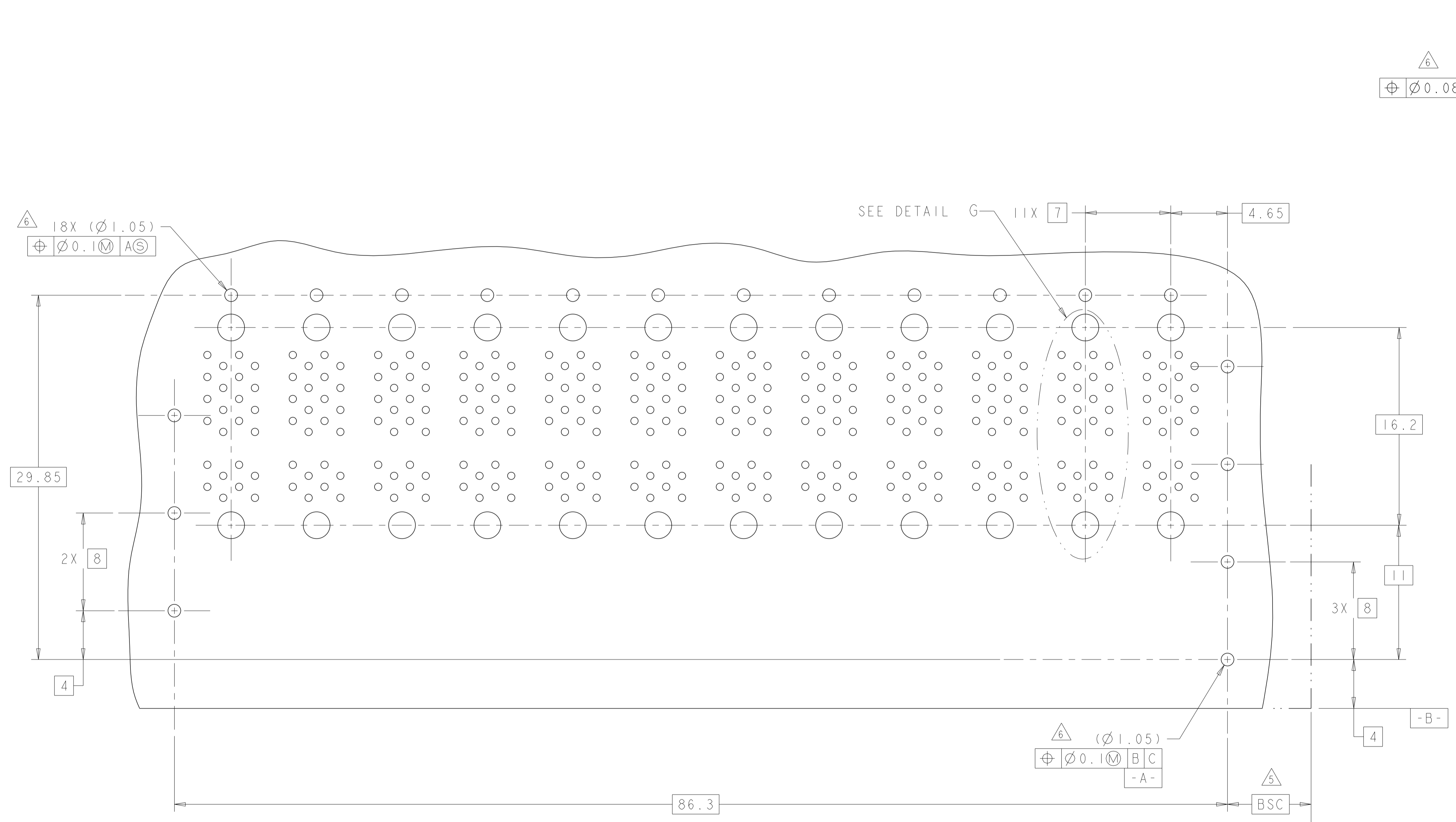

RECOMMENDED PCB LAYOUT  
 SCALE 5:1

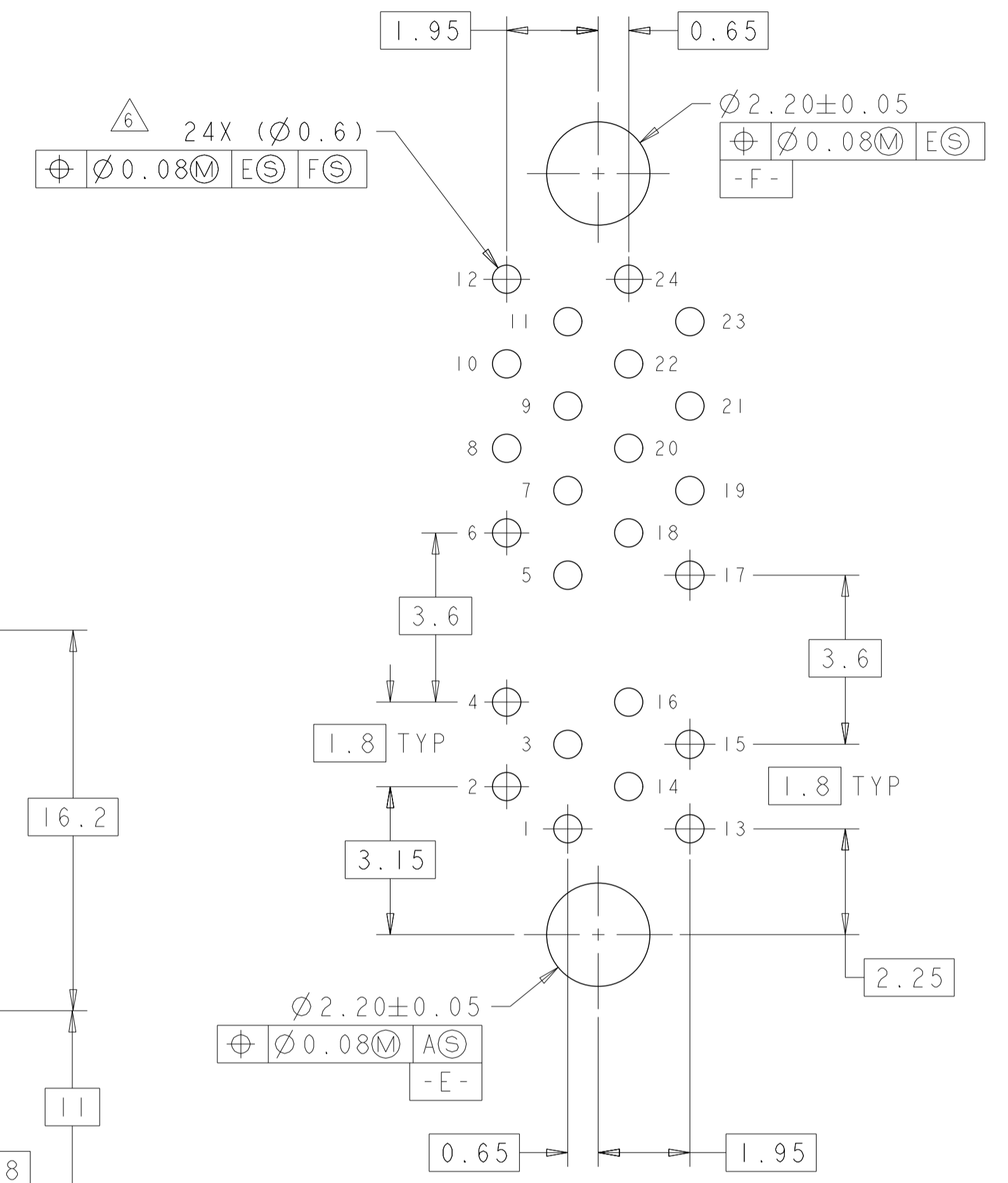

DETAIL G  
 BOARD PIN IDENTIFIERS  
 SCALE 10:1

THIS DRAWING IS A CONTROLLED DOCUMENT.		DWN M. SHIRK 08APR2008	TE Connectivity NAME RECEPTACLE ASSEMBLY, 2X12, NON MAGNETICS, RJ POINT FIVE
DIMENSIONS: mm		CHE B. HENRY 08APR2008	
TOLERANCES UNLESS OTHERWISE SPECIFIED: 0 PLC ± 1 PLC ± 2 PLC ±0.25 3 PLC ± 4 PLC ± ANGLES ±° MATERIAL - FINISH -		APVD B. HENRY 08APR2008 PRODUCT SPEC 108-2341 APPLICATION SPEC - WEIGHT - CUSTOMER DRAWING	
SCALE 3:1		SIZE A1	CAGE CODE C=2057134 DRAWING NO. 100779 SHEET 2 OF 5 REV C

LOC		DIST		REVISIONS				
P	LTR	DESCRIPTION	DATE	OWN	APVD			
-	-	SEE SHEET 1	-	-	-			

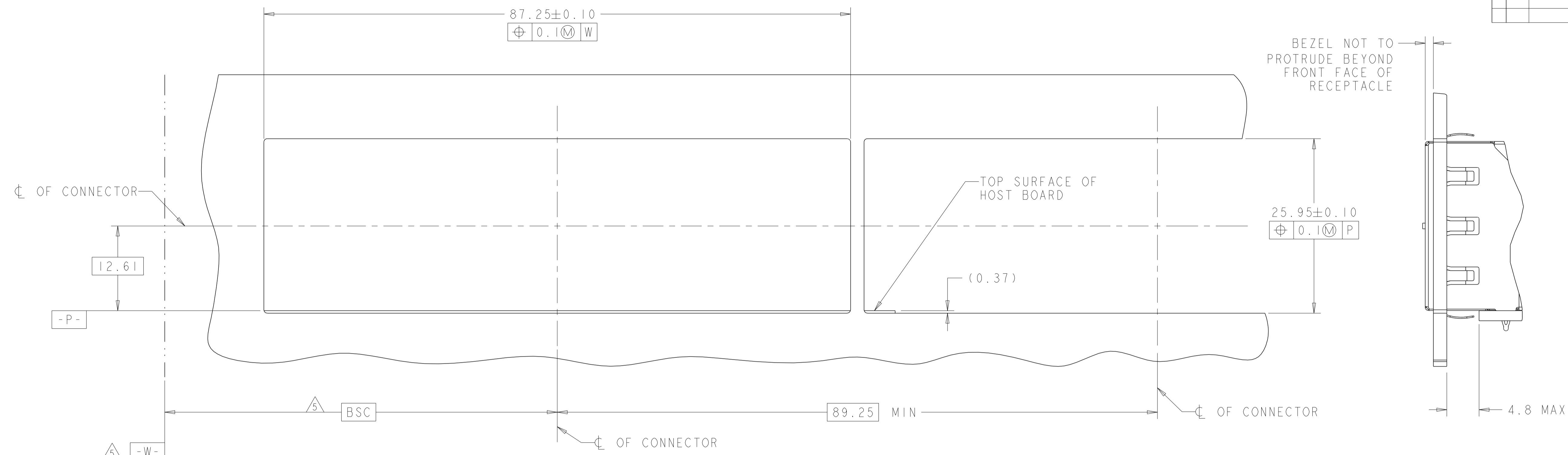

RECOMMENDED PANEL CUTOUT

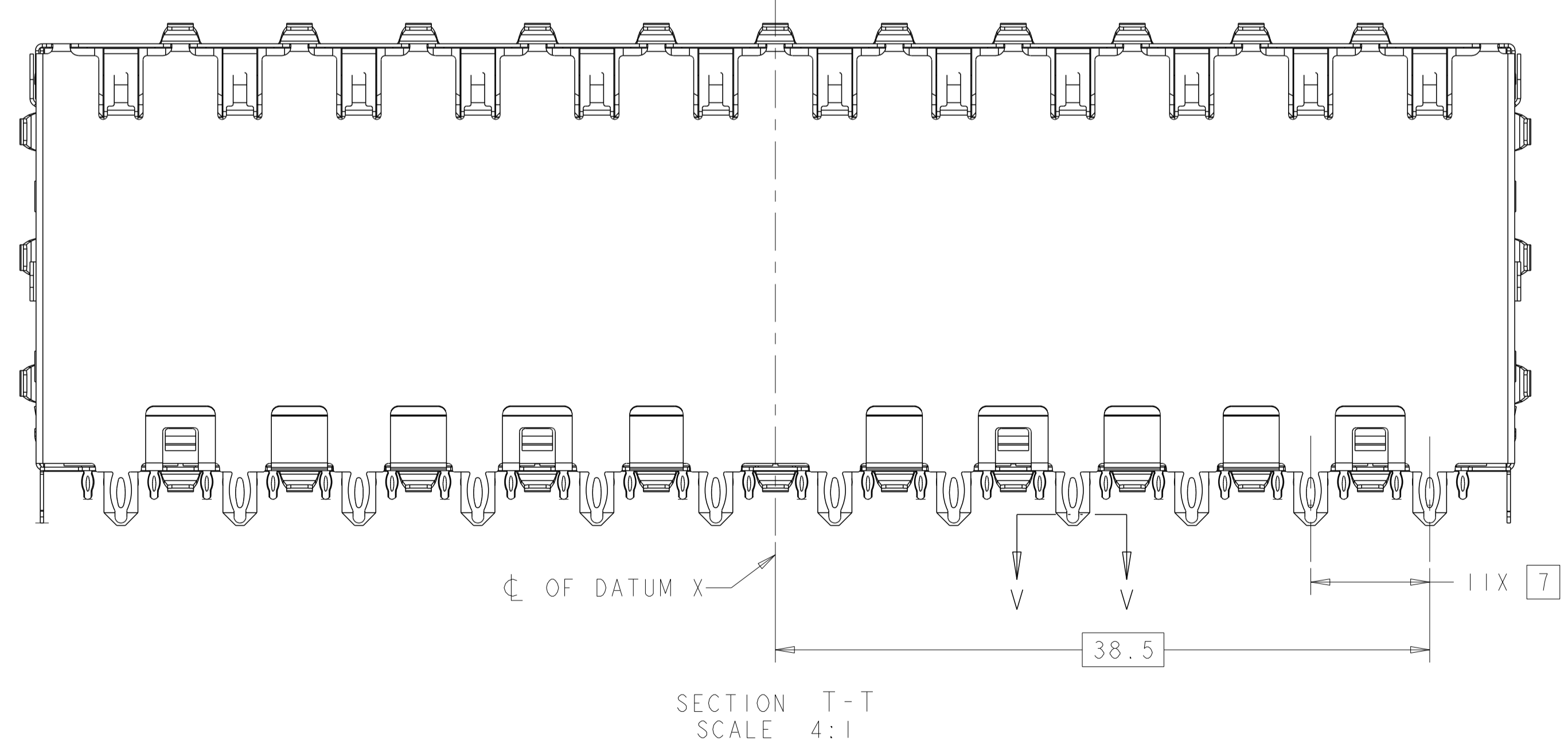
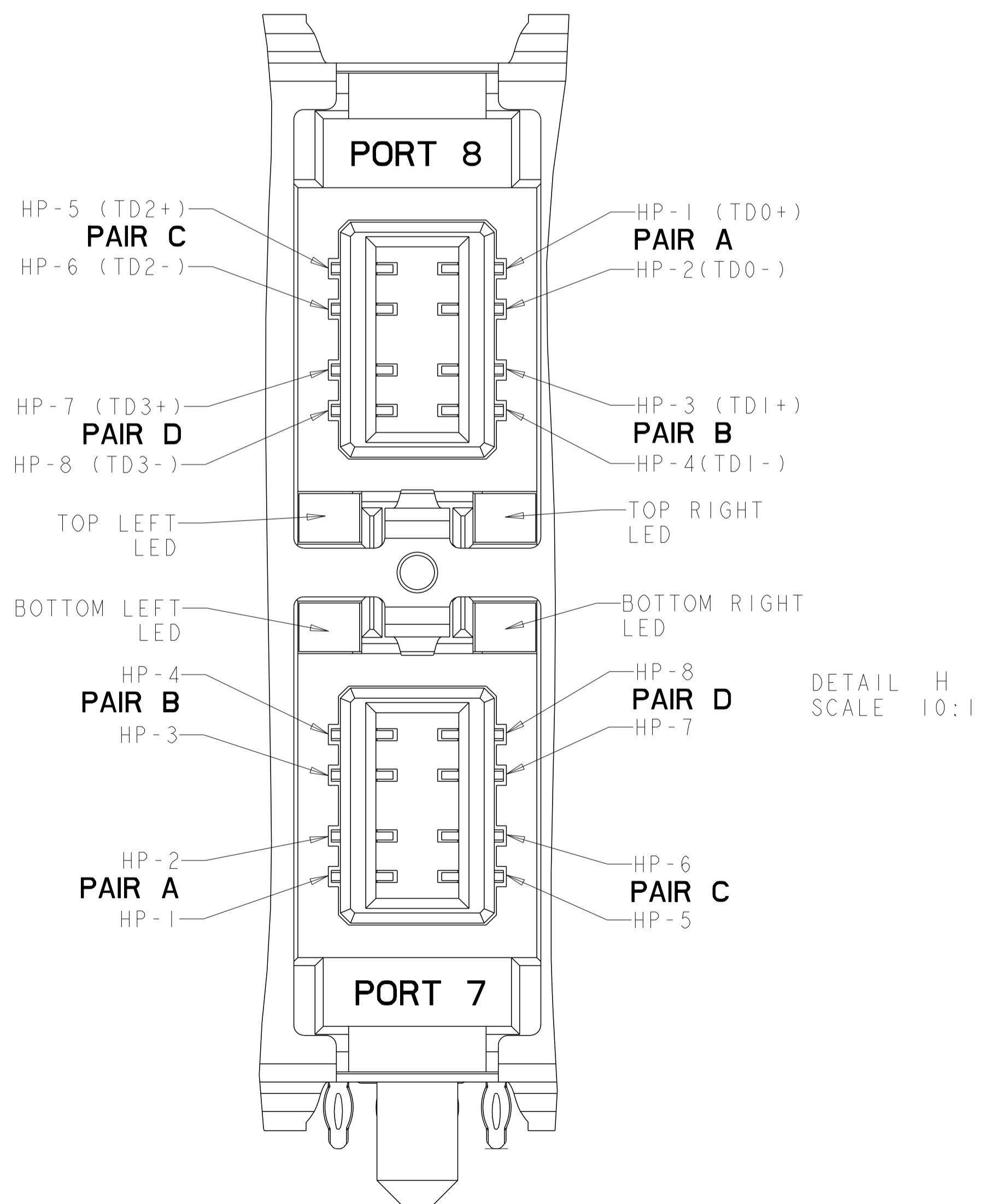
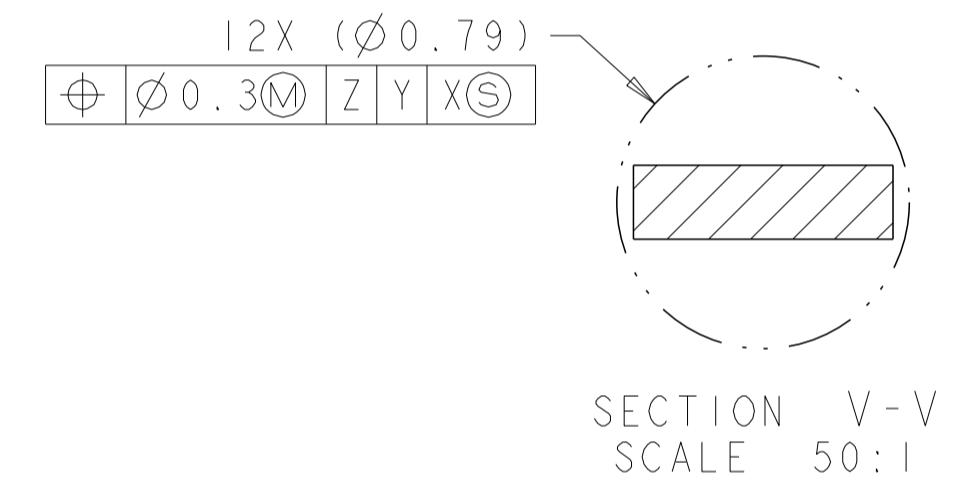

THIS DRAWING IS A CONTROLLED DOCUMENT.		DWN M. SHIRK 08APR2008	APVD B. HENRY 08APR2008	TE Connectivity RECEPTACLE ASSEMBLY, 2X12, NON MAGNETICS, RJ POINT FIVE
DIMENSIONS: mm 0 PLC ± 1 PLC ± 2 PLC ±0.25 3 PLC ± 4 PLC ± ANGLES ±° FINISH		TOLERANCES UNLESS OTHERWISE SPECIFIED: 0 PLC ± 1 PLC ± 2 PLC ±0.25 3 PLC ± 4 PLC ± ANGLES ±° FINISH		
MATERIAL		CUSTOMER DRAWING		SIZE: A1 CAGE CODE: 00779 DRAWING NO: 2057134 SCALE: 3:1 SHEET: 3 OF 5 REV: C

LOC		DIST		REVISIONS				
AG	00	P	LTR	DESCRIPTION	DATE	DWN	APVD	
		-	-	SEE SHEET 1				

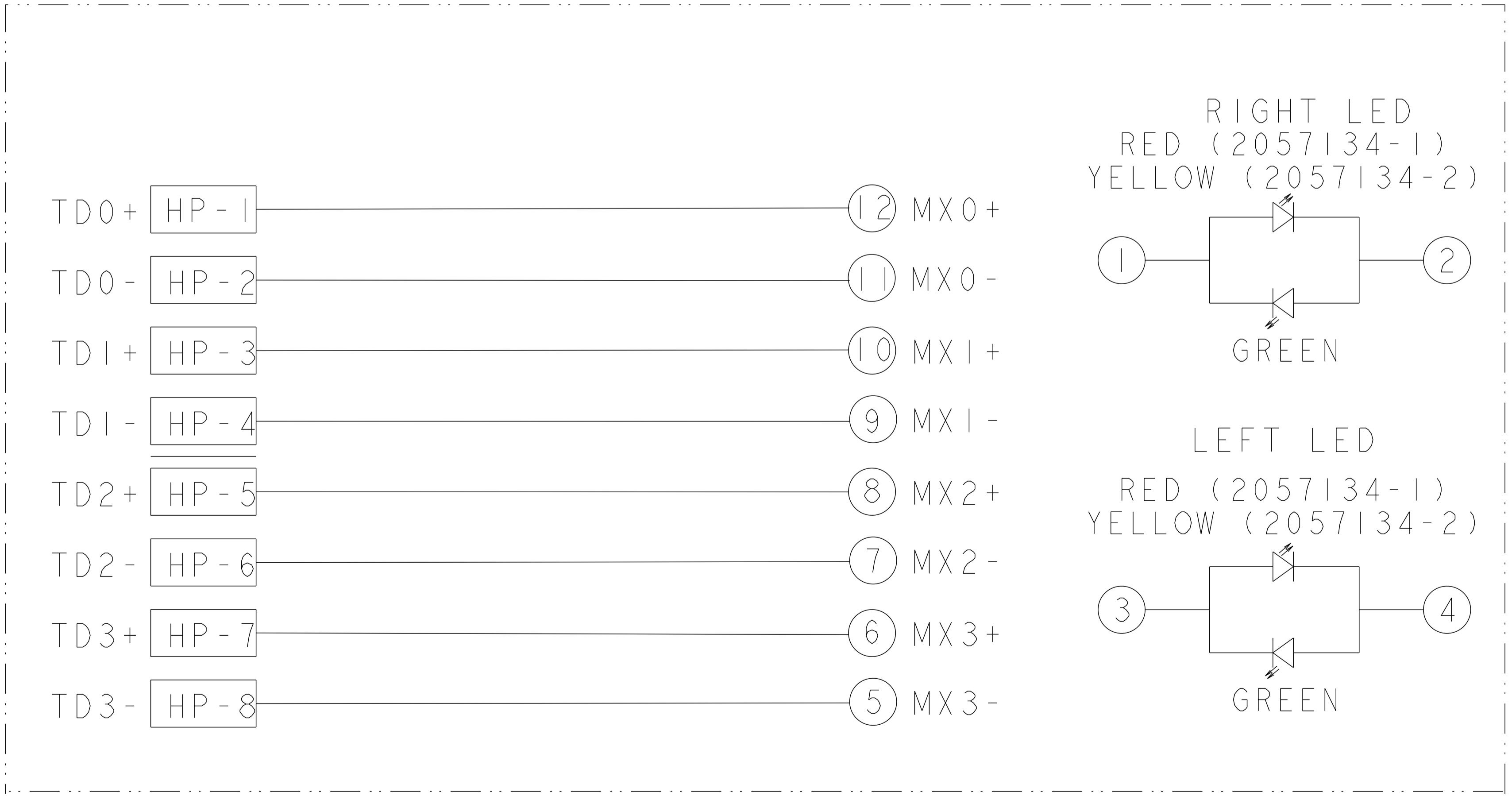
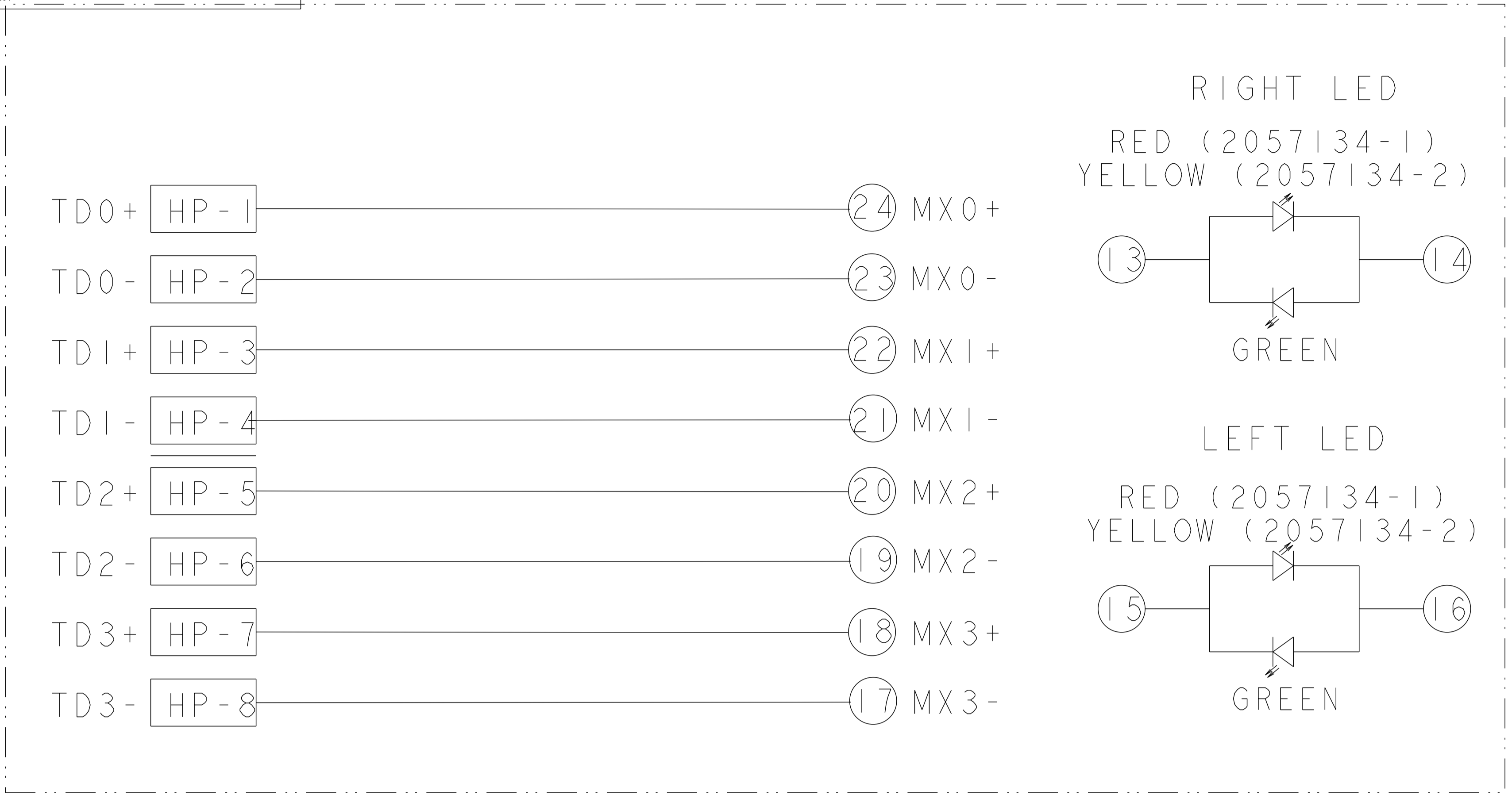

THIS DRAWING IS A CONTROLLED DOCUMENT.		DWN M. SHIRK 08APR2008	08APR2008	TE Connectivity
DIMENSIONS: mm		CHE B. HENRY 08APR2008	08APR2008	
TOLERANCES UNLESS OTHERWISE SPECIFIED:		APVD B. HENRY 08APR2008		NAME RECEPTACLE ASSEMBLY, 2X12, NON MAGNETICS, RJ POINT FIVE
0 PLC ± 1 PLC ± 2 PLC ±0.25 3 PLC ± 4 PLC ± ANGLES ±° FINISH		PRODUCT SPEC 108-2341 APPLICATION SPEC		
MATERIAL		WEIGHT	SIZE A 100779	DRAWING NO. C=2057134
		CUSTOMER DRAWING	SCALE 3:1	SHEET 4 OF 5
			REV C	

LOC	DIST	REVISIONS					
AG	00	P	LTR	DESCRIPTION	DATE	DWN	APVD
		-		SEE SHEET 1	-	-	-

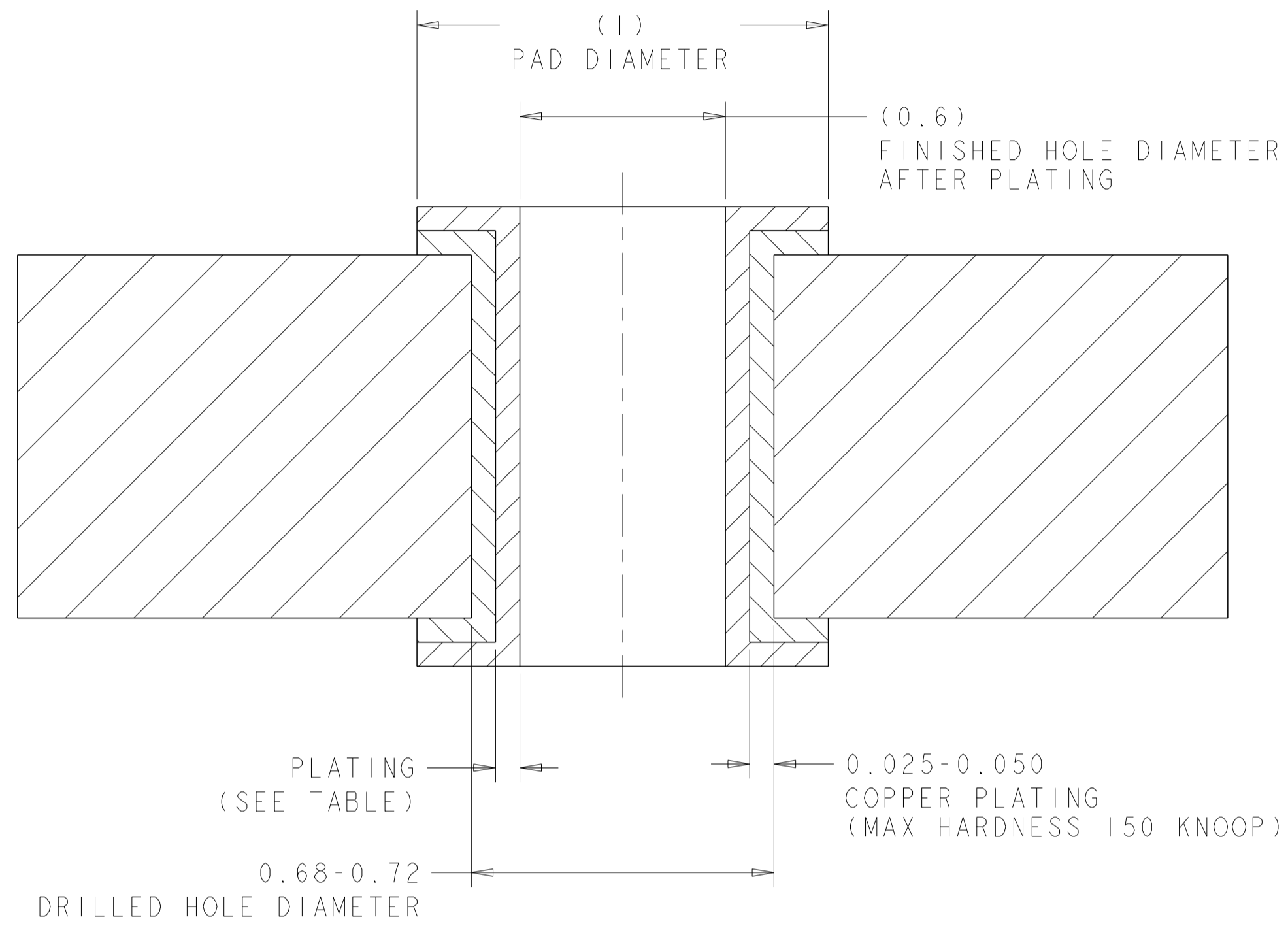

**RECOMMENDED HOLE DIMENSIONS FOR SIGNAL CONTACTS**

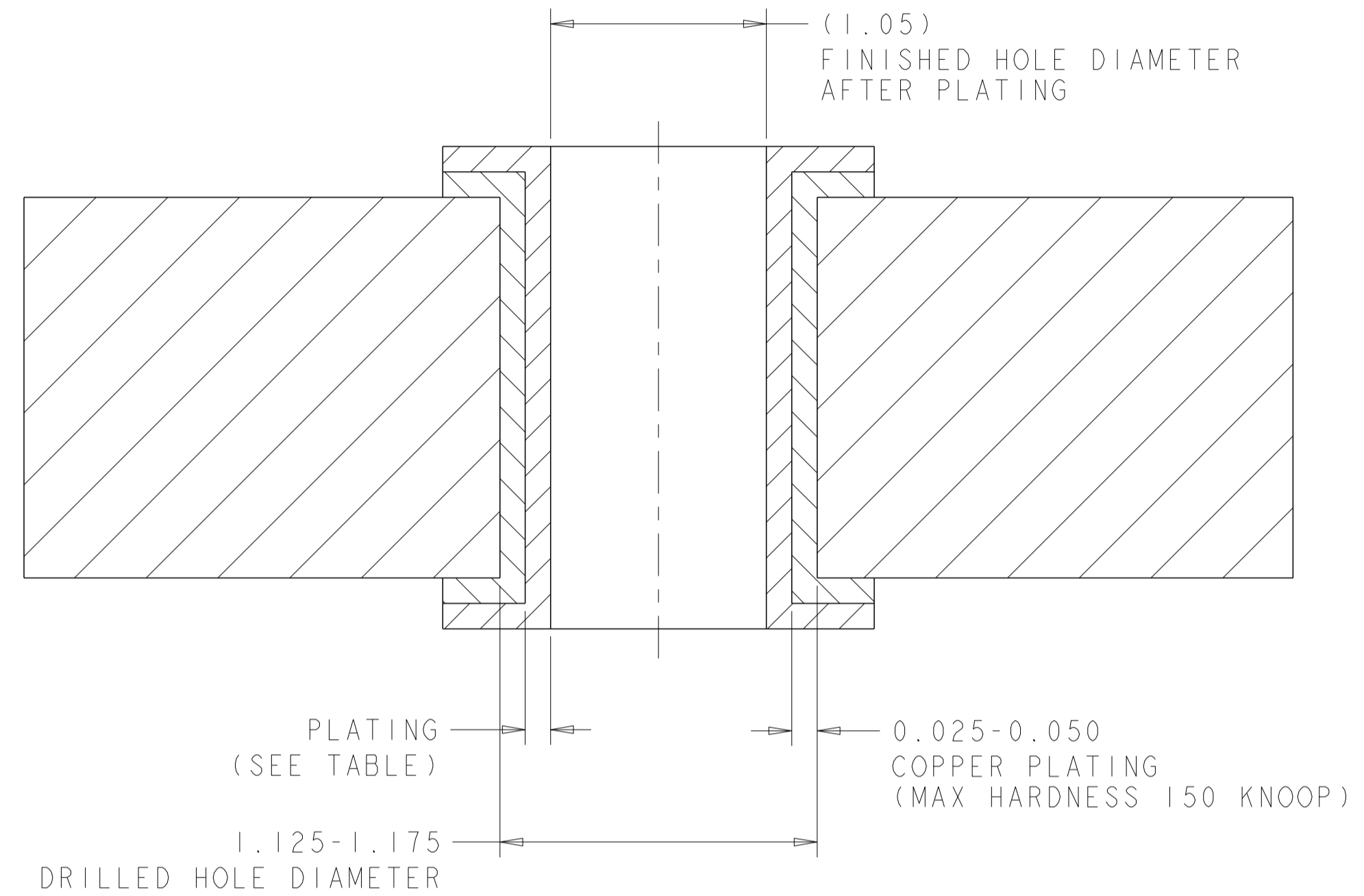

**RECOMMENDED HOLE DIMENSIONS FOR SHIELD PINS**

THICKNESS	PLATING
0.004-0.010	HOT AIR SOLDER LEVELING (HASL) TIN-LEAD (Sn Pb)
0.0005-0.001	IMMERSION TIN (Sn)
0.0002-0.0005	ORGANIC SOLDERABILITY PRESERVATIVE (OSP)
0.0001-0.0005 Au, 0.004-0.0076 Ni	IMMERSION GOLD (Au) OVER NICKEL (Ni) (ENIG)
0.010-0.025	TIN LEAD PLATING (Sn Pb)
0.0001-0.00015	IMMERSION SILVER (Ag)

THIS DRAWING IS A CONTROLLED DOCUMENT. DWN M. SHIRK 08APR2008  
 CWR B. HENRY 08APR2008  
 APVD B. HENRY 08APR2008

**STE** TE Connectivity

NAME RECEPTACLE ASSEMBLY, 2X12, NON MAGNETICS, RJ POINT FIVE  
 PRODUCT SPEC 108-2341  
 APPLICATION SPEC

DIMENSIONS: mm  
 TOLERANCES UNLESS OTHERWISE SPECIFIED:  
 0 PLC ±  
 1 PLC ±  
 2 PLC ±0.25  
 3 PLC ±  
 4 PLC ±  
 ANGLES ±°  
 FINISH

MATERIAL - WEIGHT -

SIZE A1 CAGE CODE 00779 DRAWING NO. 2057134 RESTRICTED TO -  
 CUSTOMER DRAWING SCALE 3:1 SHEET 5 OF 5 REV C